

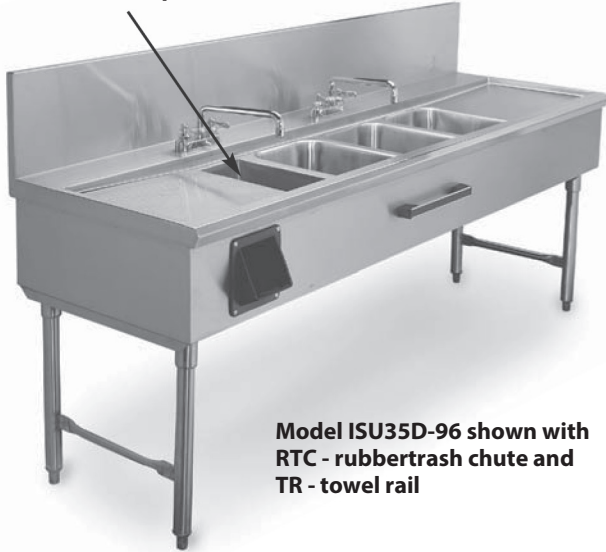

6" Wide dump sink placed on left unless otherwise specified



Model ISU35D-96 shown with RTC - rubber trash chute and TR - towel rail

3.5 COMPARTMENT SINK

PROJECT: _____
 ITEM NUMBER: _____ QTY: _____

3.5 COMPARTMENT SINK

MODELS

'S' SERIES 20-1/2" DEEP

- ISU3.5S-48 ISU3.5S-66 ISU3.5S-84
- ISU3.5S-60 ISU3.5S-66L ISU3.5S-96
- ISU3.5S-60L ISU3.5S-66R ISU3.5S-108
- ISU3.5S-60R ISU3.5S-72 ISU3.5S-120

'D' SERIES 24" DEEP

- ISU3.5D-48 ISU3.5D-66 ISU3.5D-84
- ISU3.5D-60 ISU3.5D-66L ISU3.5D-96
- ISU3.5D-60L ISU3.5D-66R ISU3.5D-108
- ISU3.5D-60R ISU3.5D-72 ISU3.5D-120

STANDARD FEATURES

- All Heliarc welded construction
- All 18-Gauge, Type 304 stainless steel
- Attractive high polished bullnose edge-to-front
- 1-5/8" diameter, 16-Gauge stainless steel legs
- Adjustable stainless steel bullet feet
- Heavy duty stainless steel gussets welded to 14-Gauge stainless steel channel supports
- Drainboards have 4" wide 18-Gauge, Type 304, steel support channels and run full length and depth of drainboards
- Drainboard top has continuous corrugation
- Drainboards pitch positively into bowls
- Sink bowls are 18-Gauge, Type 304 stainless steel
- Standard bowl size 10"x 14"x 10" deep with 1-1/2" stainless steel drain and standpipe overflow
- Deck mounted faucet with 12" swing spout



INFINITY KITCHEN PRODUCTS, INC.

7750 Scout Ave. • Bell Gardens, CA 90201
 Toll Free: (866) 349-0005 • Ph: (562) 806-5771 • Fax: (562) 806-6771
 infinitystainless.com • customerservice@infinitystainless.com

OPTIONS

- CA** Cut Away Apron for Trash Can
- CB** Cabinet Base
- EEF** Electric Eye Faucet
- LS** Lift Out Strainer Basket
- LSS** Left Side Splash
- RP** Removable Panels
- RSS** Right Side Splash
- RS10** Glass Rack Storage for 10" x 20" Racks on legs with cut away apron
- RS20** Glass Rack Storage for 20" x 20" Racks on legs with cut away apron
- RS10C** Glass Rack Storage for 10" x 20" Racks (CB Models)
- RS20C** Glass Rack Storage for 20" x 20" Racks (CB Models)
- RTC** Rubber Trash Chute in Front Apron
- SF** Special Brand Faucet
- TC** Plastic Trash Can
- TR** Towel Rail
- USS** 'S' Series Undershelf
- USD** 'D' Series Undershelf
- M** Modified - Custom

3.5 COMPARTMENT SINK

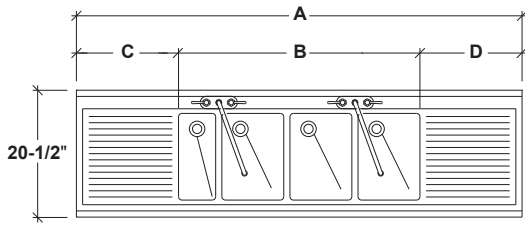

'S' SERIES PLAN VIEW

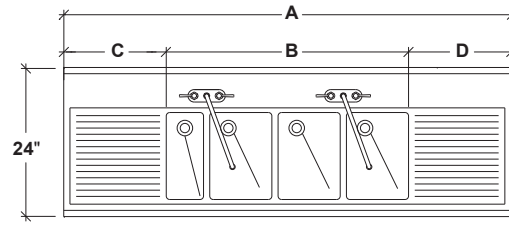

'D' SERIES PLAN VIEW

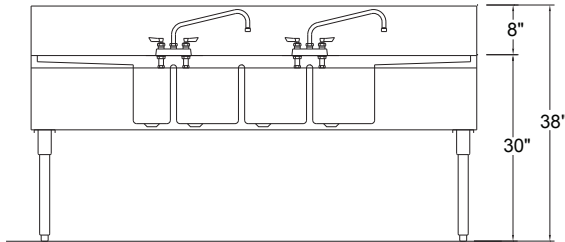

'S' SERIES ELEVATION

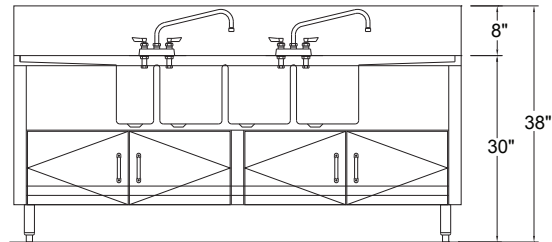

'D' SERIES ELEVATION
(WITH OPTIONAL CABINET BASE)

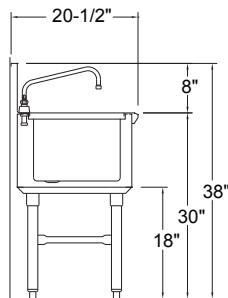

'S' SERIES SECTION

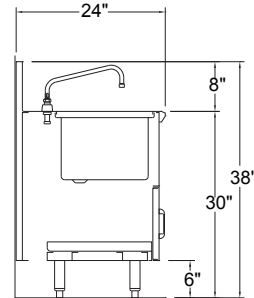

'D' SERIES SECTION
(WITH OPTIONAL CABINET BASE)

'S' & 'D' SERIES 3.5 COMPARTMENT SINKS WITH 10" x 14" x 10" BOWLS

'S' MODEL NO.	'D' MODEL NO.	A	B	C	D	DRAINBOARD SIDE	'S' WEIGHT	'D' WEIGHT
ISU3.5S-48	ISU3.5D-48	48"	39"	4-1/2"	4-1/2"	LEFT & RIGHT	130	140
ISU3.5S-60	ISU3.5D-60	60"	39"	10-1/2"	10-1/2"	LEFT & RIGHT	150	160
ISU3.5S-60L	ISU3.5D-60L	60"	39"	19-1/2"	1-3/4"	LEFT	150	160
ISU3.5S-60R	ISU3.5D-60R	60"	39"	1-3/4"	19-1/2"	RIGHT	150	160
ISU3.5S-66	ISU3.5D-66	66"	39"	13-1/2"	13-1/2"	LEFT & RIGHT	165	175
ISU3.5S-66L	ISU3.5D-66L	66"	39"	25-1/4"	1-3/4"	LEFT	165	175
ISU3.5S-66R	ISU3.5D-66R	66"	39"	1-3/4"	25-1/4"	RIGHT	165	175
ISU3.5S-72	ISU3.5D-72	72"	39"	16-1/2"	16-1/2"	LEFT & RIGHT	175	185
ISU3.5S-84	ISU3.5D-84	84"	39"	22-1/4"	22-1/4"	LEFT & RIGHT	190	200
ISU3.5S-96	ISU3.5D-96	96"	39"	28-1/2"	28-1/2"	LEFT & RIGHT	220	230
ISU3.5S-108	ISU3.5D-108	108"	39"	34-1/2"	34-1/2"	LEFT & RIGHT	250	260
ISU3.5S-120	ISU3.5D-120	120"	39"	40-1/2"	40-1/2"	LEFT & RIGHT	275	285

UTILITIES

COLD WATER	HOT WATER	DRAIN
2 x 1/2"	2 x 1/2"	4 x 1-1/2"

Proudly Made in America