



**PROJECT:** \_\_\_\_\_

**ITEM NUMBER:** \_\_\_\_\_ **QTY:** \_\_\_\_\_



Model IICS-42P10 with optional ISRS-42 (3) IWS3



Fully Welded Interior with 3/8 Radius Corners

# ICE CHEST

## MODELS

### 'S' SERIES 20-1/2" DEEP WITHOUT COLD PLATE

- IICS-12       IICS-30       IICS-48
- IICS-18       IICS-36
- IICS-24       IICS-42

### 'S' SERIES 20-1/2" DEEP WITH 10 CIRCUIT COLD PLATE

- IICS-24P10     IICS-36P10     IICS-48P10
- IICS-30P10     IICS-42P10

### 'D' SERIES 24" DEEP WITHOUT COLD PLATE

- IICD-12       IICD-30       IICD-48
- IICD-18       IICD-36
- IICD-24       IICD-42

### 'D' SERIES 24" DEEP WITH 10 CIRCUIT COLD PLATE

- IICD-24P10     IICD-36P10     IICD-48P10
- IICD-30P10     IICD-42P10

## STANDARD FEATURES

- All Heliarc welded construction
- All 18-Gauge, Type 304 stainless steel
- One-piece seamless top and backsplash
- Attractive high polished bullnose edge-to-front
- Easy clean bin with 3/8" radius interior corners
- 1" x 3" brass drain (with non-cold plate models)
- CFC-Free "shot-in-place" insulation
- 1-5/8" diameter, 16-gauge stainless steel legs
- Adjustable stainless steel bullet feet
- 12-1/2" deep fabricated ice bin carries full length
- 6" Beverage line notch in backsplash (with cold plate models)
- Stainless steel ice divider

## OPTIONS

- 16B**      16" Deep Ice Bin
- BLN12**    12" Beverage (liquor line) Notch in Splash
- CB**      Cabinet Base
- CT(#)**    Condiment Tray with Stainless Steel 1/9 Pans
- DT**      Dual Temp
- IWS(#)**    'S' Series Bottlewell
- IWD(#)**    'D' Series Bottlewell
- LSS**      Left Side Splash
- PB**      Perforated False Bottom  
(only with non-cold plate models)
- RSS**      Right Side Splash
- SC**      Stainless Steel Sliding Cover
- M**      Modified - Custom



### INFINITY KITCHEN PRODUCTS, INC.

7750 Scout Ave. • Bell Gardens, CA 90201  
 Toll Free: (866) 349-0005 • Ph: (562) 806-5771 • Fax: (562) 806-6771  
 infinitystainless.com • customerservice@infinitystainless.com

Proudly Made in America

**ICE CHEST**

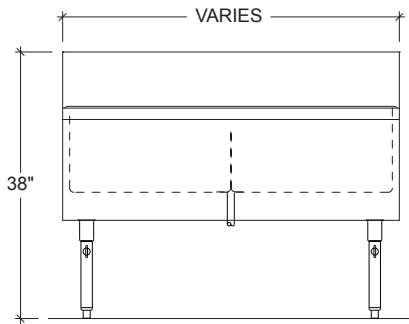

**TYPICAL SECTION**

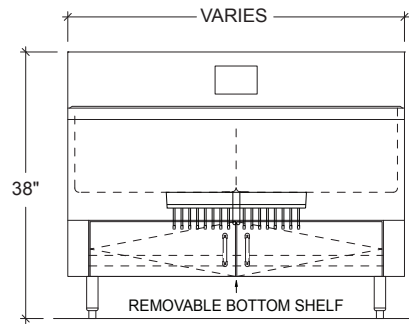

**TYPICAL ELEVATION  
(WITH OPTIONAL COLD PLATE AND CABINET BASE)**

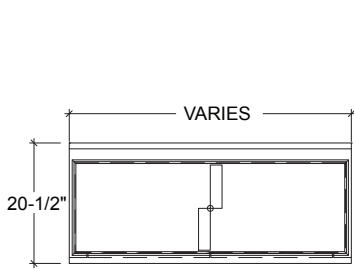

**'S' SERIES PLAN VIEW**

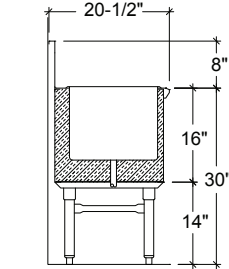

**'S' SERIES SECTION**

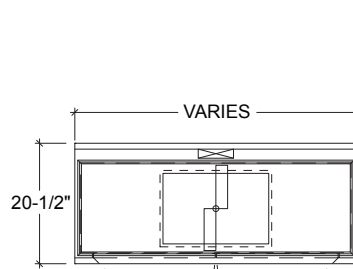

**'S' SERIES PLAN VIEW**

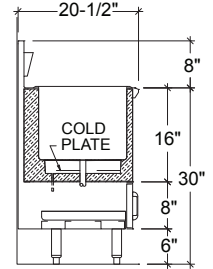

**'S' SERIES SECTION**

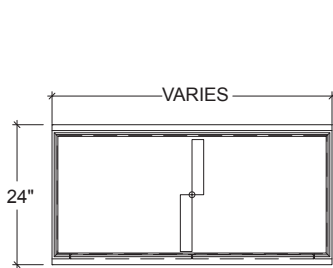

**'D' SERIES PLAN VIEW**

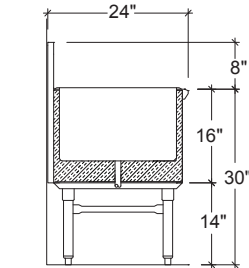

**'D' SERIES SECTION**

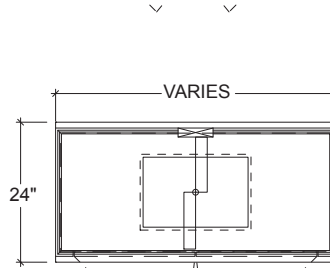

**'D' SERIES PLAN VIEW**

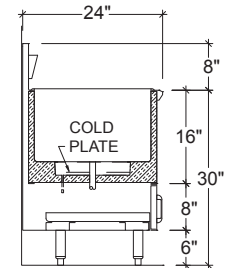

**'D' SERIES SECTION**

<b>'S' SERIES 20-1/2" DEEP WITHOUT COLD PLATE</b>				
MODEL NO.	LENGTH	ICE CAPACITY	WEIGHT	(CB) DOOR QTY.
IICS-12	12"	45#	60	1
IICS-18	18"	65#	80	1
IICS-24	24"	81#	100	1
IICS-30	30"	101#	120	2
IICS-36	36"	122#	140	2
IICS-42	42"	144#	160	2
IICS-48	48"	166#	180	2

<b>'D' SERIES 24" DEEP WITHOUT COLD PLATE</b>				
MODEL NO.	LENGTH	ICE CAPACITY	WEIGHT	(CB) DOOR QTY.
IICD-12	12"	57#	60	1
IICD-18	18"	77#	80	1
IICS-24	24"	102#	110	1
IICD-30	30"	126#	130	2
IICD-36	36"	153#	150	2
IICD-42	42"	180#	170	2
IICD-48	48"	207#	190	2

<b>'S' SERIES 20-1/2" DEEP WITH 10 CIRCUIT COLD PLATE</b>				
MODEL NO.	LENGTH	ICE CAPACITY	WEIGHT	(CB) DOOR QTY.
IICS-24P10	24"	81#	200	1
IICS-30P10	30"	101#	220	2
IICS-36P10	36"	122#	240	2
IICS-42P10	42"	144#	260	2
IICS-48P10	48"	166#	280	2

<b>'D' SERIES 24" DEEP WITH 10 CIRCUIT COLD PLATE</b>				
MODEL NO.	LENGTH	ICE CAPACITY	WEIGHT	(CB) DOOR QTY.
IICD-24P10	24"	102#	210	1
IICD-30P10	30"	126#	230	2
IICD-36P10	36"	153#	250	2
IICD-42P10	42"	180#	270	2
IICD-48P10	48"	207#	290	2

<b>UTILITIES</b>
BRASS DRAIN
1 X 1"

<b>UTILITIES (8-10 CIRCUIT)</b>
DRAIN
1/2"

**INFINITY KITCHEN PRODUCTS, INC.** *Proudly Made in America*   
 7750 Scout Ave. • Bell Gardens, CA 90201  
 Toll Free: (866) 349-0005 • Ph: (562) 806-5771 • Fax: (562) 806-6771  
 infinitystainless.com • customerservice@infinitystainless.com