



Model IRSA-3-06-LC-SM

PROJECT: \_\_\_\_\_  
 ITEM NUMBER: \_\_\_\_\_ QTY: \_\_\_\_\_

21" LOW HEIGHT WITH DRAWERS

## 21" LOW HEIGHT WITH DRAWERS

### MODELS

#### REMOTE UNITS

- IRRA-1-02       IRRA-3-06
- IRRA-2-04       IRRA-4-08

#### SELF-CONTAINED UNITS

- IRSA-1-02       IRSA-3-06
- IRSA-2-04       IRSA-4-08

### STANDARD FEATURES

- All Heli-arc welded construction
- All 18 gauge type 304 stainless steel interior and exterior
- CFC-Free "shot-in-place" insulation
- Easy clean 3/8" radius interior corners
- Polypropylene breaker strip is foamed-locked in-place
- High compression magnetic vinyl door and gasket
- Drawers each accommodates two 6" deep, full size pans, side-by-side
- Pre-wired electrical conduit is internally installed within inner and outer walls
- Blower coil with expansion valve, thermostat and solenoid valves (on remote units)
- Self-contained units supplied with compressor compartment with condensing unit, condensate expansion pan, cord and plug
- 14 gauge stainless steel drawer track system with 2" skate wheels

### MODEL CONFIGURATION

Example: **ISRA-3-06-LC-ST**



<b>1</b>	<b>RL</b> = Remote <b>SL</b> = Self-Contained
<b>3</b>	<b>1</b> = One Section <b>2</b> = Two Section <b>3</b> = Three Section <b>4</b> = Four Section
<b>4</b>	<b>02</b> = Two Drawer <b>04</b> = Four Drawer <b>06</b> = Six Drawer <b>08</b> = Eight Drawer
<b>5</b>	(On Self-Contained Units) <b>LC</b> = Condensing Compartment on Left Side <b>RC</b> = Condensing Compartment on Right Side

### OPTIONS

- CL** 6" High S/S Adjustable Legs
- CS4** 4" Heavy Duty Casters
- CS6** 6" Heavy Duty Casters
- DT** Dual Temp
- F** Freezer
- KR** Kick Rail
- MD3** Mega Drawer (accommodates 3 full size pans, side-by-side) Call factory for unit sizes
- M** Modified - Custom
- SM** S/S Top Marine All Around
- ST** Stainless Steel Top



**INFINITY KITCHEN PRODUCTS, INC.**  
 7750 Scout Ave. • Bell Gardens, CA 90201  
 Toll Free: (866) 349-0005 • Ph: (562) 806-5771 • Fax: (562) 806-6771  
 infinitystainless.com • customerservice@infinitystainless.com

*Proudly Made in America*

# 21" LOW HEIGHT WITH DRAWERS

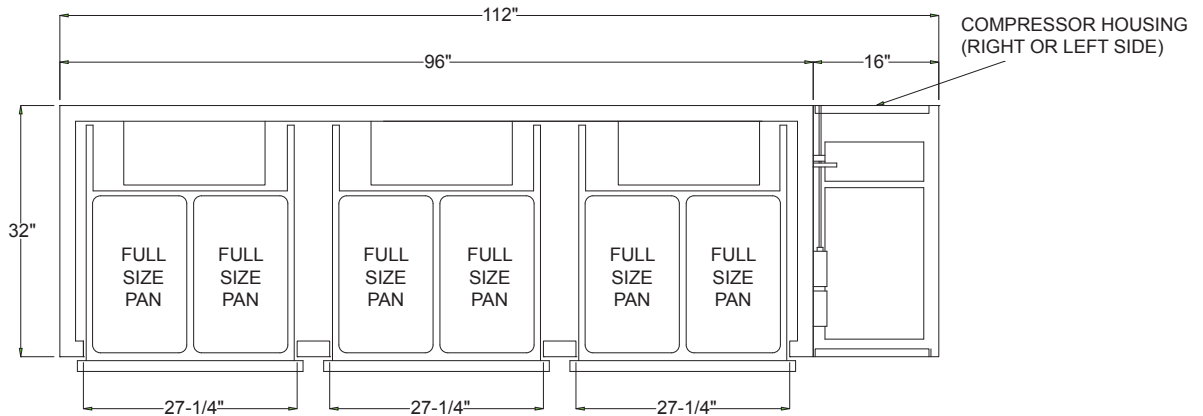

**PLAN VIEW**  
**MODEL SHOWN: IRSA-3-06**

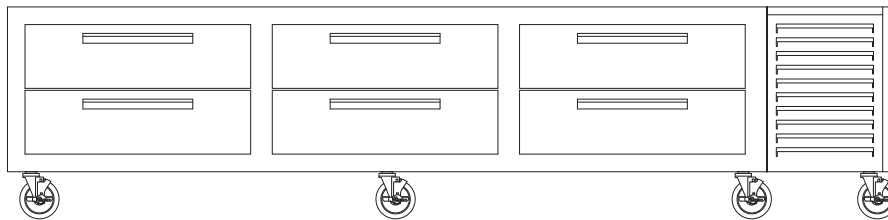

**ELEVATION**

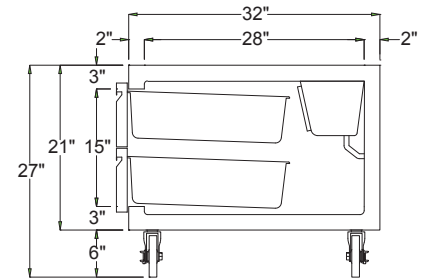

**SECTION**

## REMOTE UNITS

MODEL	LENGTH	VOLTS	TOTAL AMPS	MIN. CIRCUIT BKT.	MAX CIRCUIT BKT.	PHASE	BTU'S	WEIGHT
IRRA-1-02	33-1/4"	115v	1.34	1.6A	15A	1ph	725	240
IRRA-2-04	63"	115v	2.24	3.0A	15A	1ph	1475	415
IRRA-3-06	92"	115v	3.47	4.4A	15A	1ph	2200	600
IRRA-4-08	121"	115v	4.8	6.0A	15A	1ph	2950	750

## SELF-CONTAINED UNITS

MODEL	LENGTH	H.P	VOLTS	TOTAL AMPS	MIN. CIRCUIT BKT.	MAX CIRCUIT BKT.	PHASE	BTU'S	WEIGHT
IRSA-1-02	49-1/2"	1/3 HP	115v	8.26	10.2A	15A	1ph	725	510
IRSA-2-04	94-1/4"	1/3 HP	115v	9.2	11.5A	15A	1ph	1475	570
IRSA-3-06	109"	1/3 HP	115v	9.3	11.6A	15A	1ph	2200	760
IRSA-4-08	138-3/4"	1/2 HP	115v	12.4	15.4A	20A	1ph	2950	1010

### INFINITY KITCHEN PRODUCTS, INC.

7750 Scout Ave. • Bell Gardens, CA 90201  
Toll Free: (855) 737-4688 • Ph: (562) 806-5771 • Fax: (562) 806-6771  
infinitystainless.com • customerservice@infinitystainless.com

*Proudly Made  
in America*